

Parts Description/Accessories Name

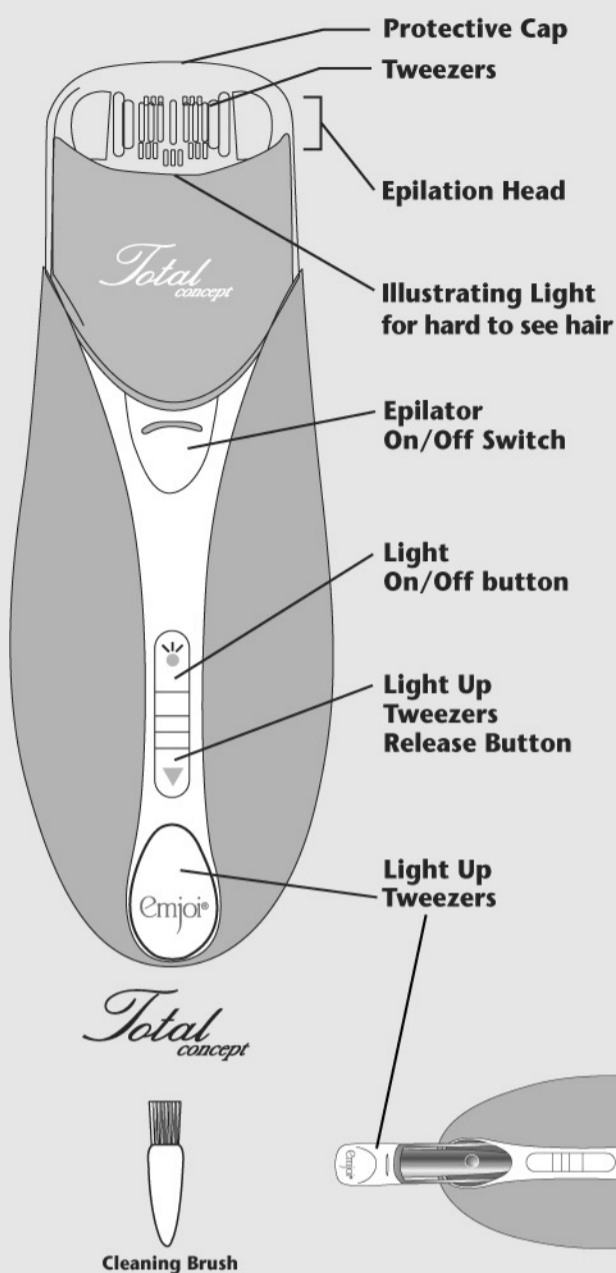

Instructions for use

For ultimate results take a warm bath or shower and use a loofa, in small circles to remove dead skin and open pores. Doing this before you use your **Emjoi® Total Concept** will help to make the hair removal process more comfortable.

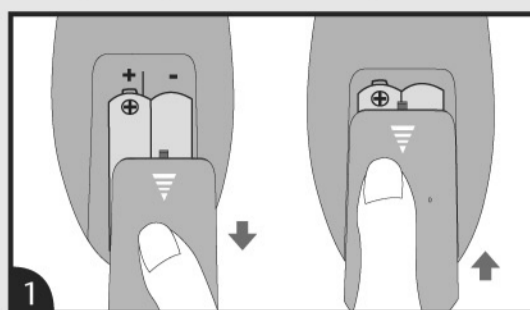

Open the battery compartment and install 2 AA alkaline batteries as indicated inside the battery compartment.

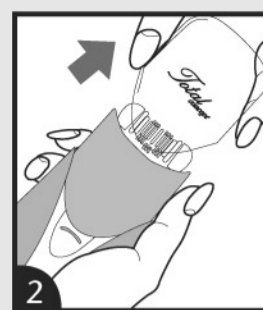

Remove plastic protective cover.

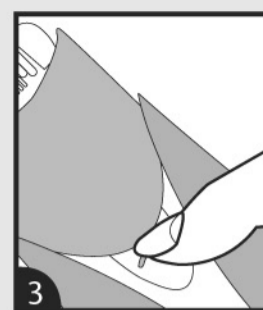

Slide the Epilator On/Off button up to turn on the unit and down to turn off the unit.

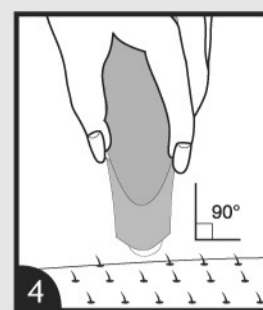

Hold the unit in your palm, at a 90° angle, so the Emjoi logo is facing you. Do not apply pressure; the safety touch control stops unit if it is pressed too hard against the skin. Just glide the unit over the surface of the skin.

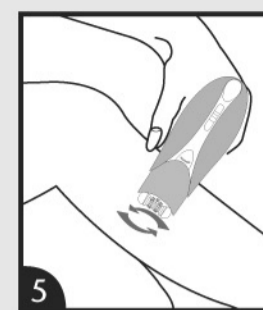

Use short, quick brush like or sweeping motions in the direction of hair growth.



Take extra care to extend the leg behind the raised button once. Press the raised button once again to turn the light Off.



May be used for the bikini line (hold area taut with one hand).

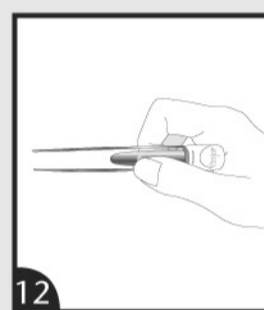

Turn the light On by pressing the raised button once. Press the raised button once again to turn the light Off.

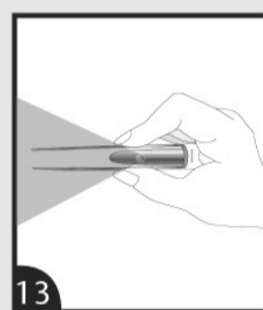

The light up tweezers can now be used to remove individual hair all over the body.



Epilator can be used to remove individual hair from the upper lip and chin area.

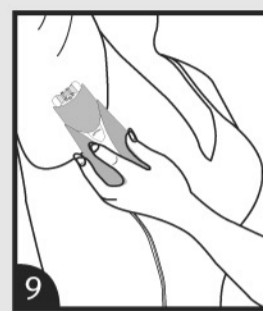

May be used to remove hair from underarms (extend your arm so skin is stretched taut).

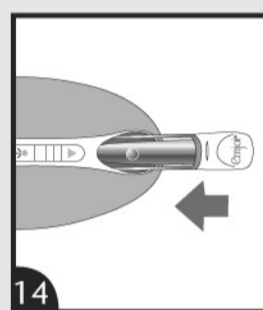

When you finish using the light up tweezers replace it into the unit.

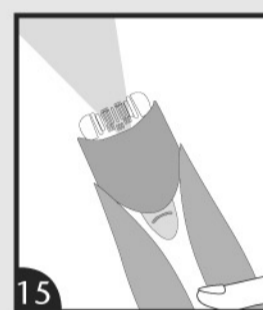

To use the light feature when using the epilator unit, press the Light On/Off button once and the light will come out from the epilator head.

Warranty

The **Emjoi® Total Concept** warranty against defects in material and workmanship lasts one year from the date of purchase.

Keep original receipt for warranty service.

During this warranty period, return the product to Emjoi, Inc. with proof of purchase to FDR Station, PO Box 7406, New York, NY 10150. Emjoi will take care of repair, or at their discretion, replacement of a defective unit without charge. For questions regarding this policy you may call toll free 1-888-99-EMJOI (1-888-993-6564).

Important: This warranty does not cover damages resulting from accidents, misuse, alterations, abuse, lack of reasonable care, or performance of services or repairs by an unauthorized service center. The manufacturers and distributors of the **Emjoi® Total Concept** do not assume responsibility for any damage caused by misuse or use other than that described in these instructions.

Model No. AP-17LT
US Patent No. 5,976,157
Other Patents Pending
© Soft Lines International Ltd. 2008

www.emjoi.com

PK-IB-EMJ-17LT-01-0

Total
concept



Battery-operated

The actual colors of the unit may vary from the photo shown on the packaging.

Total
concept

Before using your **Emjoi® Total Concept**, please read all these instructions carefully and completely.

The **Emjoi® Total Concept** is an ingenious hair remover with 2 products in 1. It combines **Emjoi's** patented tweezer disc system with a light up single hair tweezers. The epilator has 18 tweezer discs to remove hair from the root on legs, face, bikini line and underarms leaving your skin silky smooth skin for up to 6 weeks. The stainless steel tweezers is great for shaping eyebrows and removing single hair in sensitive areas. The built in light allows you to remove hair accurately the first time. The **Emjoi® Total Concept** is the only tool you will need for silky smooth skin.

When using an epilator for the first time we suggest that you test the unit on an area that has light hair growth in order to get accustomed to the epilation process.

Caution

Do not store or use your **Emjoi® Total Concept** where it can fall into a tub or sink or water.

Before using your **Emjoi® Total Concept** for the first time, we recommend using the unit on the back of your hand or ankle to familiarize yourself with the unit. The uncomfortable sensation you might feel at first will diminish as you continue to use your **Emjoi® Total Concept**.

Instructions for use

Using The Epilator

For best results: Take a warm bath or shower, to open up your pores, and use a loofa or exfoliation cream in small circles to exfoliate and remove dead skin from the area you wish to remove hair. Doing this before you use your **Emjoi® Total Concept** will cleanse and make your skin pliable, so removing hair will be less uncomfortable.

- Use your **Emjoi® Total Concept** in location that has a comfortable temperature to avoid perspiration.
- Make sure the areas you wish to remove hair from are clean, dry and free from moisturizing cream or oil.
- Open the battery cover, insert 2 AA alkaline batteries as indicated inside the battery compartment, and then replace the battery cover.
- Remove the protective cap, by gently pulling, from your **Emjoi® Total Concept**.
- Slide the Epilator On/Off button up to turn on the unit and down to turn off the unit.
- To turn on the light for epilator use, press the Light On/Off button once and the light will come out from the epilator head. To turn off the light, press the button once again.
- Hold the unit in your palm, at a 90° angle, so the **Emjoi® Total Concept** logo is facing you.
- To minimize discomfort, hold the skin taut surrounding the area you are removing hair from.
- Gently glide the **Emjoi® Total Concept** in short, quick, brush like or sweeping strokes in the direction of hair growth.
Note: For your protection, the safety touch control on your **Emjoi® Total Concept** stops the unit if it is pressed too hard against the skin.
- Before removing hair from the bikini line and underarms it is important to use a loofa or exfoliation cream in a warm shower or bath to remove dead skin and prevent ingrown hairs. If it has been an extended amount of time since you have removed hair from your bikini line and underarms, trim the hair with a scissor or trimmer. Make sure to hold your skin taut with one hand while removing hair.
- The **Emjoi® Total Concept** is only intended to remove single hairs from the upper lip and chin. Hold area taut and use a small brushing motion. **Do not use like an electric shaver on your entire face!**
- Repeat within each area until all unwanted hair is removed. The time required to remove unwanted hair depends on the user's hair type.
- After each use clean your **Emjoi® Total Concept**, see **Cleaning the Epilator**.
- Keep the protective cap on your unit when it is not in use.
- The protective cap is designed to protect your unit from being turned on accidentally so be sure to replace the protective cap after each use.

Using The Tweezers

- Remove the tweezers from the epilator unit by pushing down the light up tweezers release button towards the epilator bottom, and then pulling the tweezers out from the epilator unit.
- Turn the light on by pressing the raised button once. Press the button once again to turn the light off.
Note: There is 7 minutes auto-off feature with the lighted tweezers.
- Use the tweezers to shape eyebrows and remove single hair in sensitive areas.
- After each use clean the Light Up Tweezers, see **Cleaning the Tweezers**.

Cleaning The Epilator

Regular cleaning and good maintenance ensures optimum results and will extend the lifetime of your **Emjoi® Total Concept**.

- Before cleaning, make sure to turn off your unit.
- Using the brush, enclosed, remove hair on all sides of the discs.
- Put the protective cap on to safeguard the tweezers.

To Remove Residue:

To remove residue from the tweezers, use rubbing alcohol on the tip of the tweezers with a cotton swab that has been squeezed dry.
Note: Make sure that the cotton swab is not soaked with alcohol.

Cleaning The Tweezers

- Use the brush to remove hair from the tweezers.
- Use rubbing alcohol on the tip of the tweezers with a cotton swab that has been squeezed dry.

Tweezers Battery Replacement

- Unscrew the tweezers knob with **Emjoi®** logo and remove the battery.
- Dispose of the used battery with care and properly.
- Replace new battery (3 pcs AG3/LR41 battery) into the light compartment with care.
- Screw the tweezers knob until it is secured properly with the tweezers.
- Ensure the raised button for the light feature is facing up when the tweezers knob is screwed back to the tweezers.

Warning/Important

- Before using your hair remover please read all these instructions carefully and completely.
- Use the **Emjoi® Total Concept** only for purposes described in this instruction book.
- Please keep these instructions for future reference.
- This unit is intended for one person. We discourage sharing the unit with others.
- This appliance is not intended for use by persons (including children) with reduced physical, sensory or mental capabilities, or lack of experience and knowledge, unless they have been given supervision or instruction concerning use of the appliance by a person responsible for their safety.
- Household use only.
- Keep the appliance dry.
- Children should be supervised to ensure that they do not play with the appliance.
- This unit is for dry use only.
- Do not place or store the unit in direct sunlight. Please store your unit in a cool dry place at a temperature between 0 - 40°C.
- Do not store your unit where it can fall into a tub or sink of water.
- Warning** - Do not use your **Emjoi® Total Concept** while bathing or

in the shower. Your **Emjoi® Total Concept** is not waterproof or water resistant and is not intended to be used near water, in the bathtub or in the shower.

- Do not place your unit in water or drop water into your unit.
- Do not use this unit if the epilation head is damaged as this could lead to injury.
- Never use your unit if it has been damaged or dropped into water.
- Do not use your unit if it has damaged or broken tweezer discs as injury may occur.
- Do not drop or insert anything into any openings of the unit.
- Do not use your unit outdoors.
- Do not use your unit where aerosol products or oxygen is being used.
- Keep your unit out of reach of children.
- This appliance is not to be used on, by or near children or invalids.
- Only use this unit on clean, dry, lotion free skin.
- Do not use water or any other liquid on the tweezers other than rubbing alcohol.
- To prevent accidents and injury to you or damage to the unit** - when your **Emjoi® Total Concept** is in use, keep it away from the hair on your scalp, your eyebrows, eyelashes as well as clothes, brushes, wires, cords, shoelaces etc.
- Do not use the **Emjoi® Total Concept** if you have - allergic or sensitive skin that reacts to cosmetics, metals, clothing, etc., acne, body acne, warts, around moles and loose skin, diabetes, Raynaud's disease, eczema, psoriasis, hemophilia, immune deficiency, rosacea, couperose, varicose veins, wounds or when your skin has rashes or is sunburned, inflamed or irritated. Consult with your health care provider prior to use if you have any of the above conditions.
- Do not use the unit before or during menstruation, during pregnancy or for one month after giving birth unless you consult with your health care provider prior to use.
- Changes in your hormone levels (taking hormone medication, recently pregnant) can influence the color or thickness of hair growth. These changes are not caused by this product but hormonal changes.
- If you have any medical conditions, issues, questions or any sensitivity whatsoever we strongly advise you to consult with your health care provider before using this product.
- If you have a pacemaker consult with your health care provider prior to use.
- If you are epilating for the first time, we recommend doing it in the evening so any possible redness or irritation can go away overnight. We suggest testing the unit gradually over a period of two to three days to allow your skin to adjust.
- If you have never epilated before (or if it has been an extended time since you epilated) you will feel a prickling sensation when using the unit. This feeling is due to the fact that you are removing hair from the root. After a few sessions the sensation you feel should diminish.
- Removing hair from the root can cause ingrown hair and skin irritation (redness of the skin, discomfort, itching). If you know that you are prone

to ingrown hair, removing hair from the root may not be for you. Regular skin massaging with a massaging glove or loofa, may help reduce the chance or occurrence of ingrown hairs. After using the epilator you can use body cream or aloe vera to soothe the skin and any possible irritation.

- Using an epilator may cause redness or irritation of the skin. This is a normal reaction that will quickly disappear, but may be longer if you have very sensitive skin or are removing hair from the root for the first few times. If any irritation remains for more than 3 days, discontinue use and consult with your health care provider.
- Sometimes inflammation of the skin can occur when bacteria penetrates the skin. Cleaning the epilation head before and after each use can minimize the risk of infection.
- The **Emjoi® Total Concept** epilator is only intended to remove single hairs from the upper lip and chin. Hold area taut and use a small brushing motion. **The Emjoi® Total Concept is NOT an electric shaver and should NOT be used like an electric shaver on your entire face!** Using the **Emjoi® Total Concept** like an electric shaver, without holding the skin taut, could potentially allow the **Emjoi® Total Concept** to pinch or grab the skin, which could cause irritation and skin damage.
- Before removing hair from the bikini line and underarms it is important to use a loofa sponge or exfoliation cream in a warm shower or bath to remove dead skin and help minimize the chance or occurrence of ingrown hairs. If it has been an extended amount of time since you have removed hair from your bikini line and underarms (if the hair is longer than 5mm), trim the hair with a scissor or trimmer. Make sure to hold your skin taut with one hand while removing hair. Some women may experience irritation after removing hair from the underarms and bikini line for the first time. We suggest testing the unit on a small part of the skin in these areas first.
- Do not continually rub the unit on the same area or apply strong pressure.
- Keep the protective cap on your unit when it is not in use.

Frequently asked questions

Q: Does the **Emjoi® Total Concept** hurt?

A: The first time you use the **Emjoi® Total Concept** you might feel a prickling sensation, this feeling is due to the fact that you are removing hair from the root. After several uses, the tweezing becomes more comfortable even for those with sensitive skin.

Q: How should I hold the **Emjoi® Total Concept**?

A: To minimize discomfort, hold the skin surrounding the area you are removing hair from taut. Gently glide, do not apply pressure, the **Emjoi® Total Concept** in short, quick, brush like or sweeping strokes in the direction of hair growth.

Note: For your protection, your **Emjoi® Total Concept** may slow down, or stop operating completely if it is pressed too hard against the skin.

Q: Can I use the **Emjoi® Total Concept** epilator on my upper lip?

A: Yes, the **Emjoi® Total Concept** epilator is perfect for removing individual hair from the upper lip.

Important: Hold your upper lip taut and use short brushing strokes to

remove individual hairs from your upper lip. The light up tweezer can also be used to remove individual hair all over the body and to groom eyebrows.

Q: Can I use the **Emjoi® Total Concept** anywhere on my face?

A: No. The **Emjoi® Total Concept** is only intended to remove individual hairs from the upper lip and chin area. When removing hair from your upper lip and chin, hold your skin taut and use short brushing motions. **Do not use Emjoi® Total Concept** like you would for an electric shaver on your entire face. The light up tweezer can be used to remove individual hair all over the face.

Q: Can I use the **Emjoi® Total Concept** on my bikini line and underarm?

A: Yes. Before removing hair from the bikini line or underarms it is important to use a loofa sponge in a warm shower or bath to remove dead skin and prevent ingrown hairs. Since these areas can be sensitive, it is important to hold the skin taut.

Q: Will my hair grow back as fast as it does when I shave?

A: No. With shaving you are cutting the hair at the surface, so hair grows back quickly. When you use the **Emjoi® Total Concept** it removes hair from the root so it takes longer, up to 4-6 weeks, to grow back.

Q: What if my skin becomes red after using the **Emjoi® Total Concept**?

A: Whenever you remove hair from the root your skin may become red or irritated. To soothe irritation you can use lotion with aloe vera or antibiotic ointment.

Q: What can I do for ingrown hairs?

A: We recommend using a loofa or an exfoliation cream in the shower or bath to soften the skin and any ingrown hairs, enabling the **Emjoi® Total Concept** to remove the hair from the root. If any irritation remains for more than 3 days, discontinue use and consult with your health care provider.

Q: I have varicose veins, can I use the **Emjoi® Total Concept**?

A: Regarding any medical issues or questions, we strongly advise you to consult with your health care provider prior to use.

Q: Do I have to clean the **Emjoi® Total Concept**?

A: Yes. We recommend that you clean your unit after each use. Before cleaning make sure to turn off your unit. Remove the disc cover and use the brush, enclosed, to remove hair on all sides of the discs.

Q: Should I let someone else use my **Emjoi® Total Concept**?

A: No. For sanitary reasons, the **Emjoi® Total Concept** is only recommended to be used by one person.

Q: How do I turn on the light on the hair remover?

A: Press the Light On/Off button once to turn on the light and press once again to turn off the light.

Q: How do I remove the Tweezers from the hair remover?

A: Push the Light Up Tweezers Release button down towards the epilator bottom, and then pull the tweezers out from the epilator unit.

Q: Are these Tweezers stainless steel?

A: Yes, for quality and durability.

Q: How can I turn on the light on the tweezers?

A: Press the raised button once to turn the light on and press it again to turn the light off.